

## Tunnel Support Installation Instructions

### Tools needed:

electric drill w/ 3/16" drill

pop-rivet gun

c-clamp

1. Set support in place to verify fit
2. Note which existing tunnel/running board rivets the tunnel support covers. Drill out these rivets to allow the tunnel support to sit flat against the tunnel/running board. Use a 3/16" diameter drill. Do not drill out the rivet holes any larger as you will be using these holes again to mount the tunnel support.
  - a. There should be 4 on the running board that get drilled out. 2 mount the heat exchanger, and 2 mount the running board gripper. Be careful not to drill into the heat exchanger!
  - b. There should be 3 or 4 on the tunnel that get drilled out.
3. With rivets drilled out, set the tunnel support in place again.
4. Using a marker, transfer the rivet hole locations to the back side of the tunnel support, by reaching inside the tunnel and underneath the running board. You will be using the same rivet hole that you just drilled.
5. Drill a 3/16" diameter hole in the tunnel support located by the transfer marks.
6. Set the tunnel support in place.
7. Rivet the vertical side of the tunnel support in place first using the shorter rivets provided.
8. Clamp the horizontal side of the tunnel support flat against the running board. Cover the clamp jaws with a small piece of cloth so you don't scratch the tunnel supports.
9. Using the long rivets provided, rivet the tunnel support to the running board.
10. Add additional rivets as you see fit.
11. You're done!

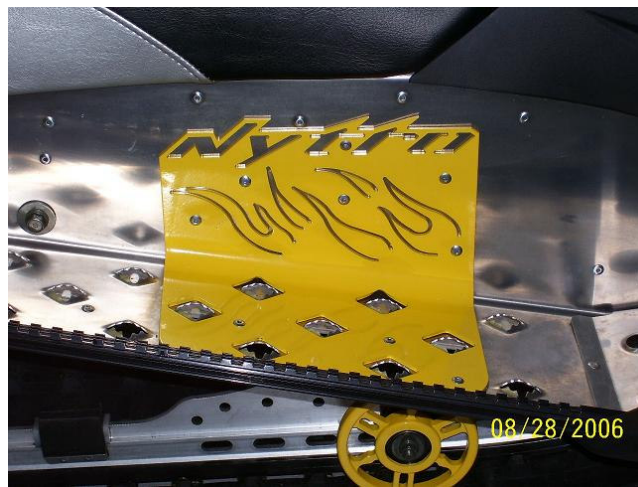

If you have the monoshock suspension, and the tunnel mounted dial adjuster:

1. You will need to remove the upper bolt identified in the picture below:

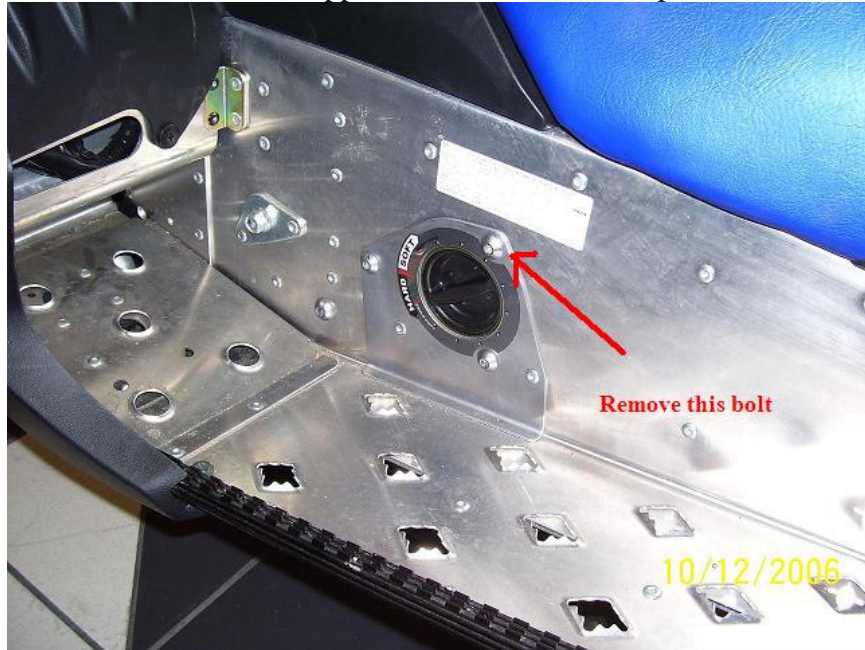

2. Install the tunnel supports as per the instructions. Then reinstall the bolt you just removed. The bolt will reinstall through a hole provided in the tunnel support.